

COMPTEUR VOLUMÉTRIQUE LXLC(R)-80~200

LXLC(R)-80~200(mm)

Removable element woltman cold (hot) water meter



Application:

--Measuring the total volume of cold(hot) water passing through the pipeline.

-NOTE:This type of water meter can be used for a reading transmission system as equipped with pulse.

Feature:

-- Dry-dial, Magnetic drive

---Vacuum sealed register ensures the dial keep free from fog and Keep the reading clear in a long term service;

--Removable element unit and strong universality, easy installation and maintenance,

--Measuring high flow rate with low head loss.

-- Remote transmission device can be added upon request,such as Reed Switch or Hall, Pulse Output:DN80-200mm 1000L/P、 100L/P.

--Technical data conform to international standard ISO 4064.

Working condition

Water temperature: T30 T50 T90

Water pressure class: MAP16 MAP10

Pressure-loss Class: $\Delta p63$

Maximum permissible errors

(1) From minimum flow-rate(Q_1) inclusive to transitional flow-rate(Q_2) exclusive $\pm 5\%$.

(2) From transitional flow-rate(Q_2) to overload flow-rate(Q_4): $\pm 2\%$;
(Hot water meter $\pm 3\%$)

MAIN TECHNICAL SPECIFICATIONS

Type	Size	Class	Q ₄	Q ₃	Q ₂	Q ₁	Min. Reading	Max. Reading
			Overload Flow	Permanent Flow	Transitional Flow	Min. Flow		
			m ³ /h				m ³	
LXLC-80	3"	R50 (R80)	78.75	63	2	1.26	0.002	999,999
LXLC-100	4"		125	100	3.2	2	0.002	999,999
LXLC-125	5"		200	160	5.12	3.2	0.002	999,999
LXLC-150	6"		312.5	250	8	5	0.002	999,999
LXLC-200	8"		500	400	12.8	8	0.002	999,999

DIMENSIONS

Type	Size	L Length	H Height	Connecting flange		
				φ D1 Outside diameter	φ D2 Bolt circle diameter	Connecting Bolts (n-M)
				mm		
LXLC-80	3"	225	279	200	160	8-M16
LXLC-100	4"	250	289	220	180	8-M16
LXLC-125	5"	250	299	250	210	8-M16
LXLC-150	6"	300	319	285	240	8-M20
LXLC-200	8"	350	346	340	295	8-M20(1.0MPa)
						12-M20(1.6MPa)

NOTE: The flange dimension conforms to ISO7005-2:1988 standard. Order for products of special requirements is also accepted.

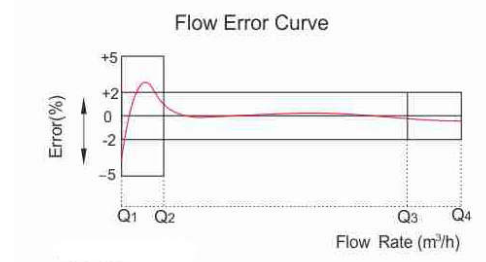
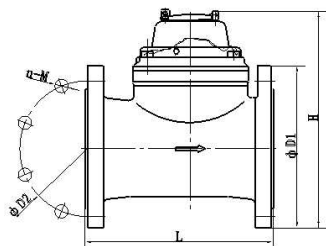

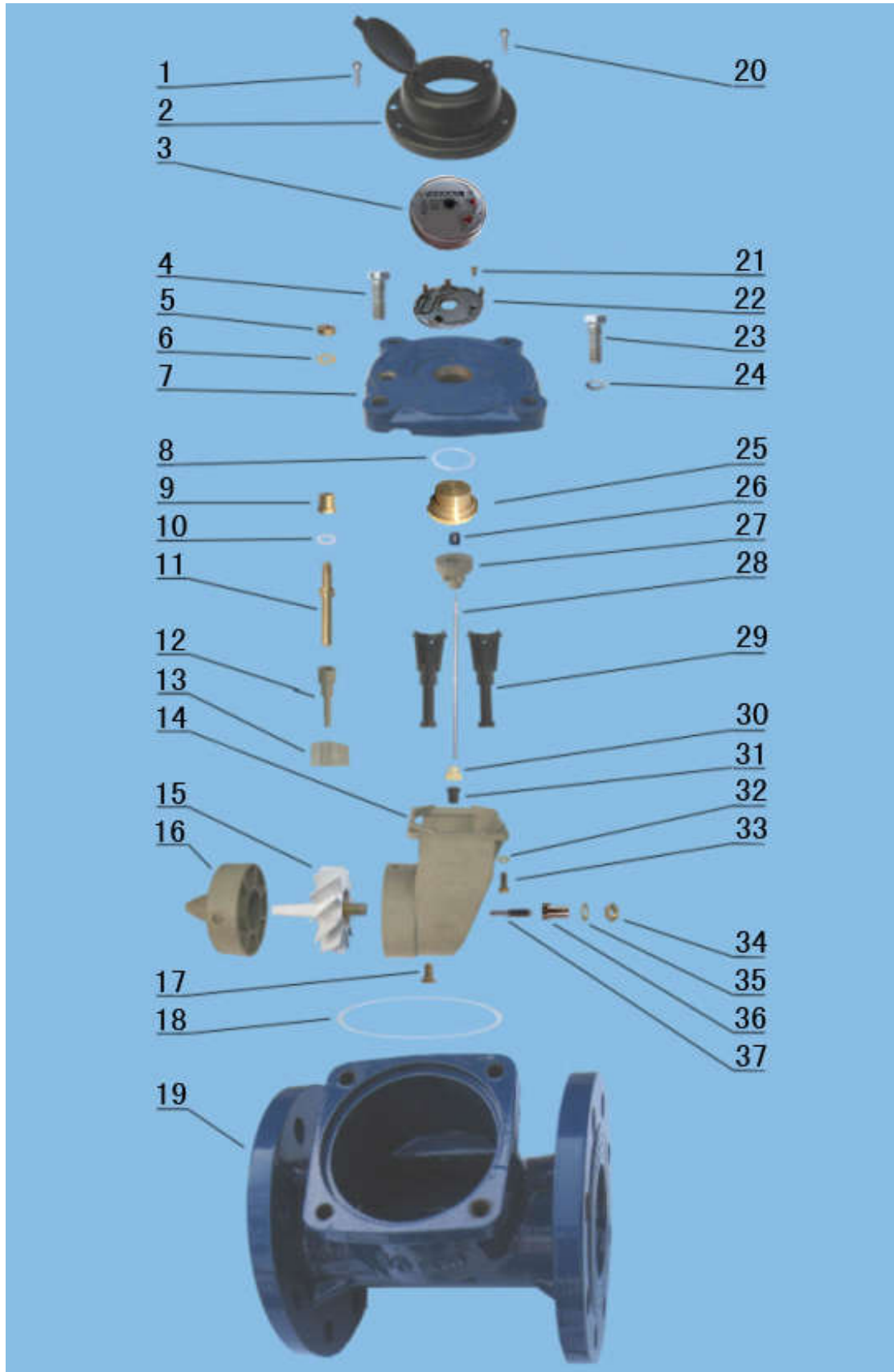

LXLC-80~200 REMOVABLE ELEMENT WOLTMAN WATER METER

Code	Description	Material	QTY
1	Screw For Sealing	Stainless Steel	1
2	Cover With Lid	Assembly	1
3	Sealed Register	Assembly	1
4	Screw M4×20	Stainless Steel	2
5	Gasket	Brass	2
6	Adjusting Nut	Brass	1
7	Flange Cover	Cast Iron	1
8	O-ring	Silicon Rubber	1
9	Bush	Brass	1
10	Gasket	Synthetic Rubber	1
11	Adjusting Lever	Brass	1
12	Connecting Lever	POM OR MPPO	1
13	Adjusting Plate	POM OR MPPO	1
14	Support	ABS OR MPPO	1
15	Turbine Component	Assembly	1
16	Rectifier	ABS OR MPPO	1
17	Screw	Brass	1
18	O-ring	Synthetic Rubber	1
19	Body	Cast Iron	1
20	Screw For Sealing	Stainless Steel	1
21	Screw For Sealing	Stainless Steel	3
22	Support	ABS	1
23	Screw M4×20	Stainless Steel	2
24	Gasket	Stainless Steel	4
25	Upper Bearing Plate	Brass	1
26	Upper Bearing	Nylon With Graphite	1
27	Magnet Component	Component	1
28	Transmission Shaft	Stainless Steel	1
29	Sheath	Nylon	2
30	Bevel Gear	POM	1
31	Bevel Gear	Nylon	1
32	Gasket	Stainless Steel	4
33	ScrewM5X12	Stainless Steel	4
34	Nut	Brass	1
35	Gasket	Brass	1
36	Turbine Shaft Hold	Brass	1
37	Turbine Shaft	Tungsten Steel	1