

COMPTEUR VOLUMÉTRIQUE LXLC(R)-40~65

LXLC(R)-40~65(mm)

Removable element woltman cold (hot) water meter



Application:

--Measuring the total volume of cold(hot) water passing through the pipeline.

-NOTE: This type of water meter can be used for a reading transmission system as equipped with pluse.

Feature:

-- Dry-dial, Magnetic drive

----Vacuum sealed register ensures the dial keep free from fog and Keep the reading clear in a long term service;

--Removable element unit and strong universality, easy installation and maintenance,

--Measuring high flow rate with low head loss.

-- Remote transmission device can be added upon request,such as Reed Switch or Hall, Pulse Output:DN40-65mm 1000L/P、 100L/P.

--Technical data conform to international standard ISO 4064..

Working condition

Water temperature: T30 T50 T90

Water pressure class: MAP16 MAP10

Pressure-loss Class: $\Delta p63$

Maximum permissible errors

(1) From minimum flow-rate(Q_1) inclusive to transitional flow-rate(Q_2) exclusive $\pm 5\%$.

(2) From transitional flow-rate(Q_2) to overload flow-rate(Q_4): $\pm 2\%$;
(Hot water meter $\pm 3\%$)

MAIN TECHNICAL SPECIFICATIONS

Type	Size	Class	Q ₄	Q ₃	Q ₂	Q ₁	Min. Reading	Max. Reading
			Overload Flow	Permanent Flow	Transitional Flow	Min. Flow		
			m ³ /h				m ³	
LXLC-40	1½"	R50 (R80)	31.25	25	0.8	0.5	0.0005	999,999
LXLC-50	2"		31.25	25	0.8	0.5	0.0005	999,999
LXLC-65	2½"		50	40	1.28	0.8	0.0005	999,999

DIMENSIONS

Type	Size	L Length	H Height	Connecting flange		
				φ D1 Outside diameter	φ D2 Bolt circle diameter	Connecting Bolts (n-M)
LXLC-40	1½"	200	210	150	110	4-M16
LXLC-50	2"	200	214	165	125	4-M16
LXLC-65	2½"	200	224	185	145	4-M16

NOTE: The flange dimension conforms to ISO7005-2:1988 standard. Order for products of special requirements is also accepted.

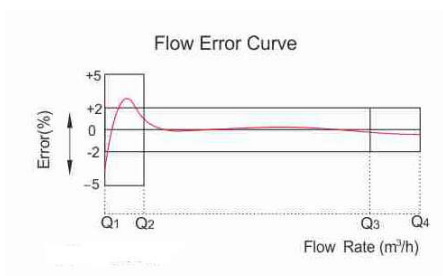
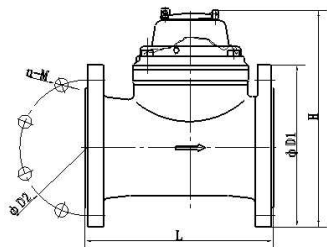

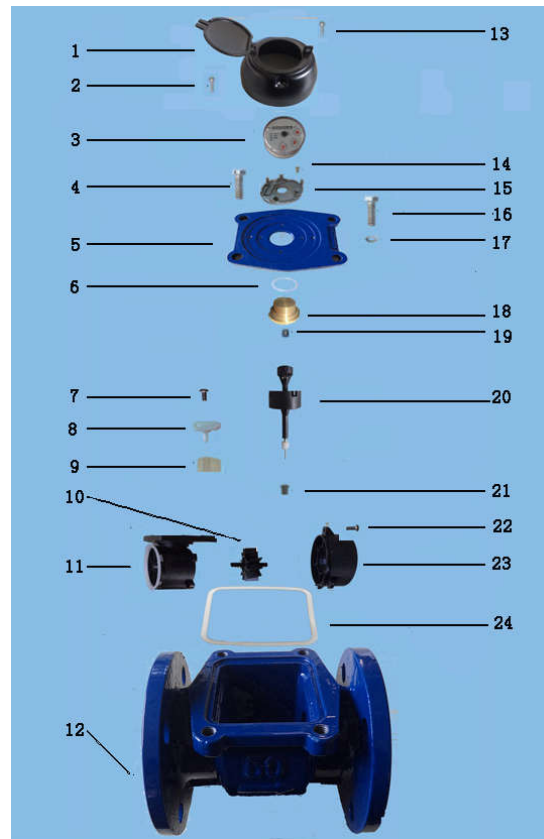

LXLC-40~65 REMOVABLE ELEMENT WOLTMAN WATER METER

Code	Description	Material	QTY
1	Screw For Sealing	Stainless Steel	1
2	Cover With Lid	Assembly	1
3	Sealed Register	Assembly	1
4	Screw M4×20	Stainless Steel	2
5	Flange Plate	Cast Iron	2
6	O-ring	Silicon Rubber	1
7	Screw	Stainless Steel	1
8	Adjusting Lever	POM OR MPPO	1
9	Adjusting Plate	POM OR MPPO	1
10	Turbine	ABS OR MPPO	1
11	Rectifier	ABS OR MPPO	1
12	Body	Casting Iron	1
13	Screw	Stainless Steel	1
14	Screw	Stainless Steel	1
15	Fixed plate	POM OR MPPO	1
16	Screw	Stainless Steel	1
17	Gasket	Stainless Steel	1
18	Upper Bearing Plate	Brass	1

19	Upper Bearing	Nylon With Graphite	1
20	Magnet Component	Component	1
21	Lower Bearing	Nylon With Graphite	1
22	Screw	Stainless Steel	1
23	Support	POM OR MPPO	1
24	Seal Gasket	Rubber	1